

Tip Out Windshield Kit

Kit Number: 793-1121-00

- Read these instructions thoroughly before installing this accessory.
- Retain these instructions for future reference.

Required Tools: 1) 5mm hex wrench 3) 15mm wrench 5) 9/16" wrench
2) 4mm hex wrench 4) 10mm wrench 6) Scissors

Kit Contents:

(Make sure all of the components shown below are present before installing this accessory)

ITEM #	Part Number	Description	Qty.
1	99163813	Windshield	1
2	99505033	Visor	1
3	99505056	Center Handle Bracket	1
4	99505055	Driver Side Frame Bracket	1
5	99505034	Passenger Side Frame Bracket	1
6	99505057	Driver Side Mounting Bracket	1
7	99505058	Passenger Side Mounting Bracket	1
8	99402558	Strap Clamp	4
9	99503156	Hinge	2
10	99505026	Spring	2
11	99505070	Rotary Latch	2
12	99801187	Adhesive Sponge Gasket	4.25 FT
13	99801186	Rubber Edge Gasket	1 FT
14	99402524	Steel Spacer	2
15	99402084	6 x 25mm Socket Head Screw	8
16	99401455	6 x 8mm Button Head Screw	2
17	99401384	6 x 25mm Button Head Screw	16
18	99401361	6 x 16mm Button Head Screw	2
19	99402535	3/8" x 2.25" Hex Head Bolt	4
20	99402132	M6 Fender Washer	6
21	99402160	1" Plug	1
22	99402159	1/2" Plug	2
23	99402060	Flange Spacer	12
24	99401928	M6 Ball Stud	4
25	99402532	6 x 45mm Carriage Bolt	2
26	99401415	M6 Nylock Flange Nut	22
27	99401123	M6 Nylock Nut (No Flange)	4

Kit Contents (Continued)

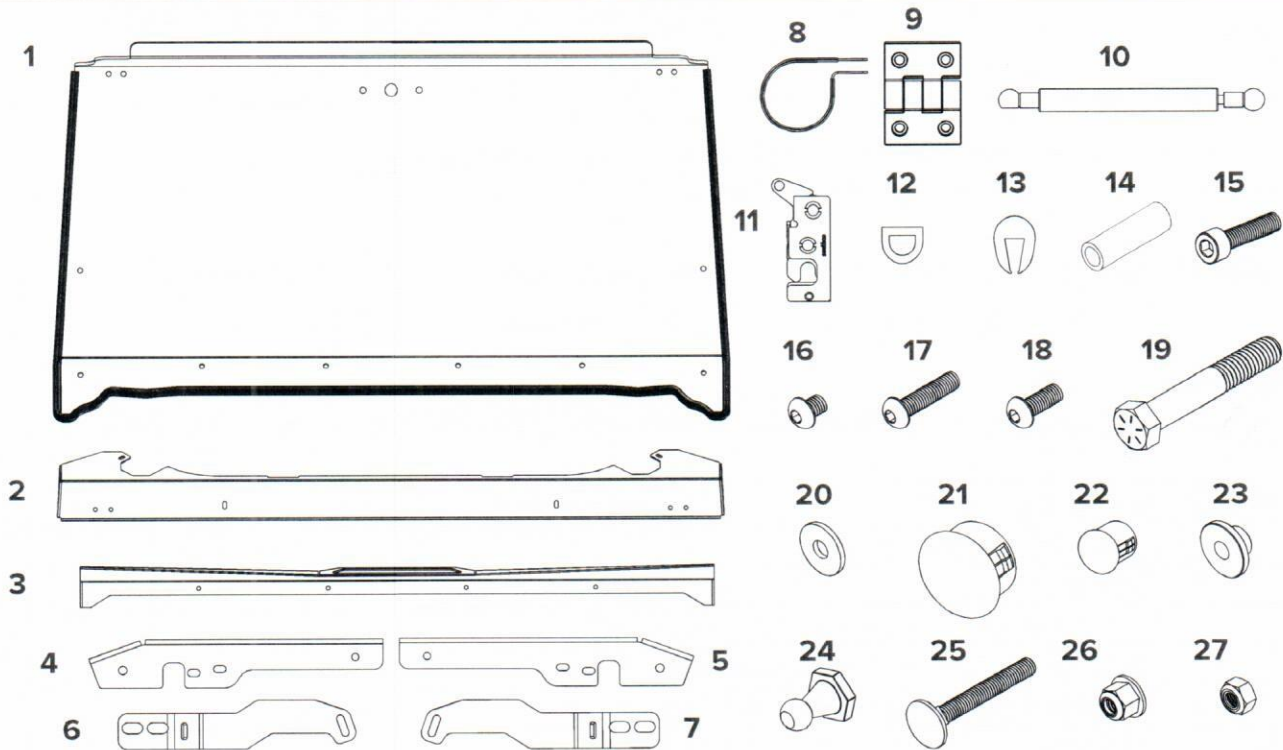

Installation Instructions

Before installing:

- Park the vehicle on a smooth and level surface.
- Turn off the ignition and remove the key.
- Set the parking brake.

1. Remove the paper backing from the Adhesive Sponge Gasket (12) and apply it to the bottom edge of the Visor (2). Press down firmly to securely adhere the gasket.

- *Cut the gasket to the correct length before installing it to the bracket*

2. Press a piece of Rubber Edge Gasket (13) onto each of the curved side edges on the Visor (2).

- *Cut the gaskets to the correct lengths before installing them to the bracket*

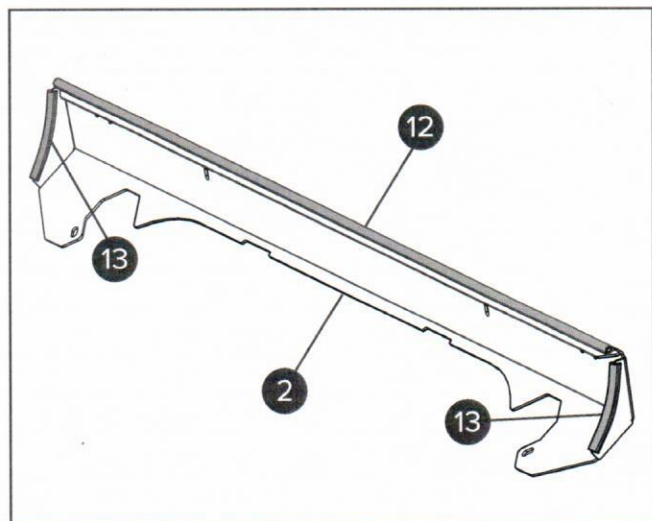

Installation Instructions

3. Install the two Hinges (9) to the front face of the Visor (2) using four 6 x 25mm Socket Head Screws (15) and M6 Nylock Flange Nuts (26).

- *The hinges are universal and can be installed in either orientation*

TORQUE: 71 in/lbs (8.0 N·m, 0.82 kgf/m)

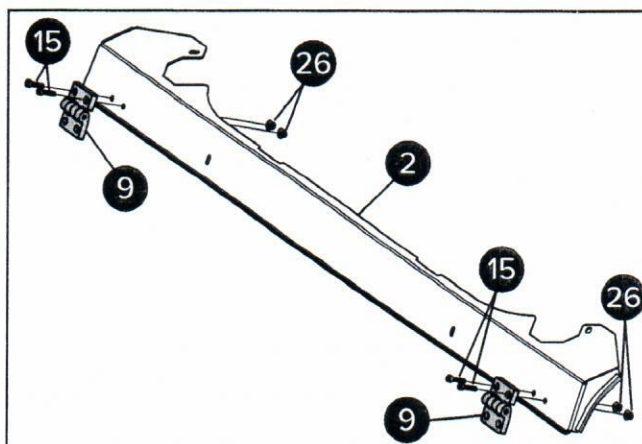

4. Orient all four Strap Clamps (8) around the front roof ROPS tube in the locations shown.

- *The flat mounting tabs on the clamps must be located towards the top and front of the tube*

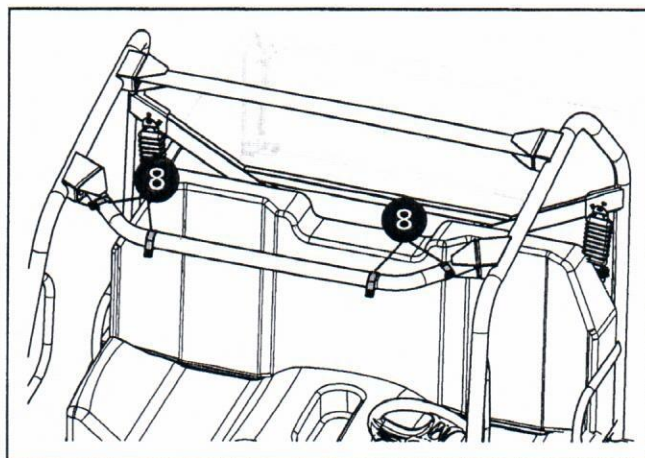

5. Using two people, lift the Visor (2) into place over the front roof ROPS tube. Loosely attach the visor to the four Strap Clamps (8) using four 6 x 25mm Button Head Screws (17), M6 Fender Washers (20), and M6 Nylock Flange Nuts (26).

6. Adjust the position of the visor so that it is centered on the ROPS tube, then tighten down the hardware securing the clamps.

TORQUE: 71 in/lbs (8.0 N·m, 0.82 kgf/m)

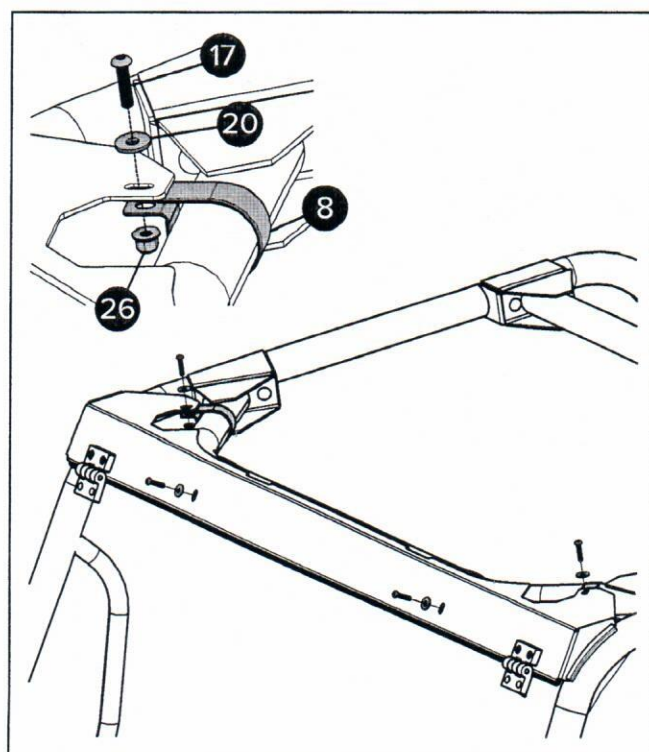

Installation Instructions

7. Press the Rubber Edge Gasket (13) onto the inside edge of the handle slot on the Center Handle Bracket (3) as shown.

- *Cut the gasket to the correct length before installing it to the bracket*

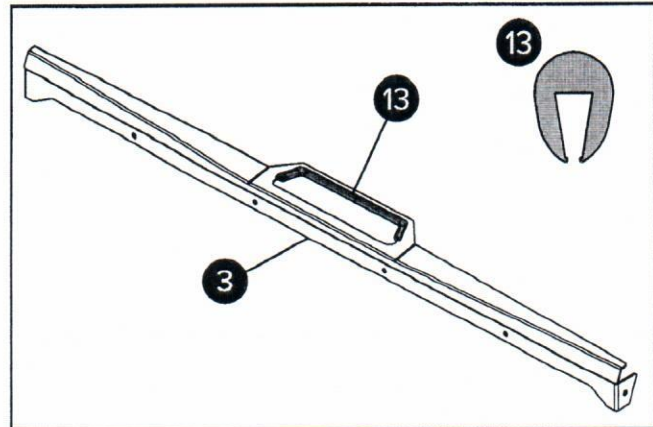

8. Install a Rotary Latch (11) to the Driver Side (4) and Passenger Side (5) Frame Brackets using four 6 x 25mm Button Head Screws (17) and M6 Nylock Nuts (27).

- *Install the latch hardware centered in the slots on the brackets at this time*

TORQUE: 71 in/lbs (8.0 N·m, 0.82 kgf/m)

9. Install an M6 Ball Stud (24) to the Driver Side (4) and Passenger Side (5) Frame Brackets using two 6 x 8mm Button Head Screws (16).

TORQUE: 71 in/lbs (8.0 N·m, 0.82 kgf/m)

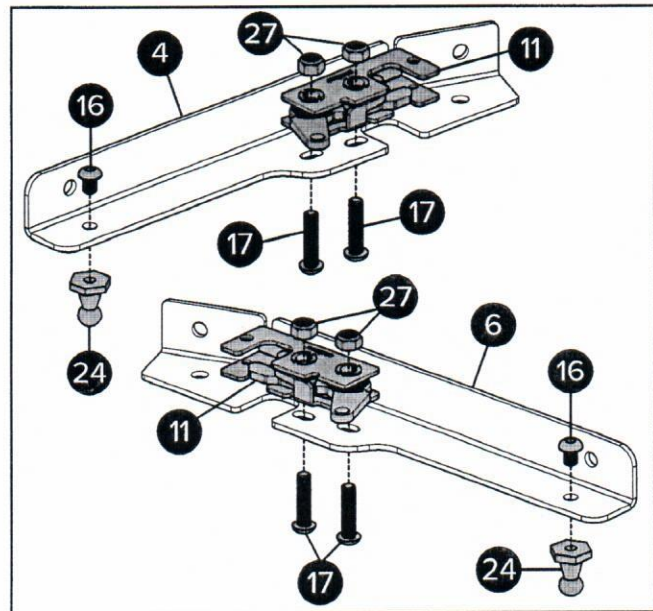

10. Install the Driver Side (4) and Passenger Side (5) Frame Brackets to the ends of the Center Handle Bracket (3) using two 6 x 16mm Button Head Screws (18) and M6 Nylock Flange Nuts (26).

- *The mounting faces on the frame brackets will line up with the mounting faces on the center handle bracket*

TORQUE: 71 in/lbs (8.0 N·m, 0.82 kgf/m)

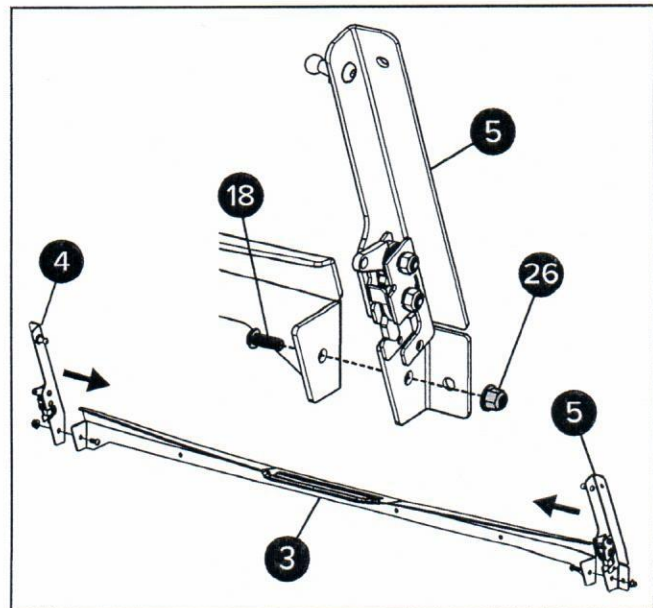

Installation Instructions

11. Place the assembled frame over the inside of the Windshield (1) with the handle slot facing up. Line up the eight holes in the frame with the holes in the windshield and install using eight 6 x 25mm Button Head Screws (17), Flange Spacers (23), and M6 Nylock Flange Nuts (26).

- The bulb side of the gasket designates the inside of the windshield

TORQUE: 71 in/lbs (8.0 N·m, 0.82 kgf/m)

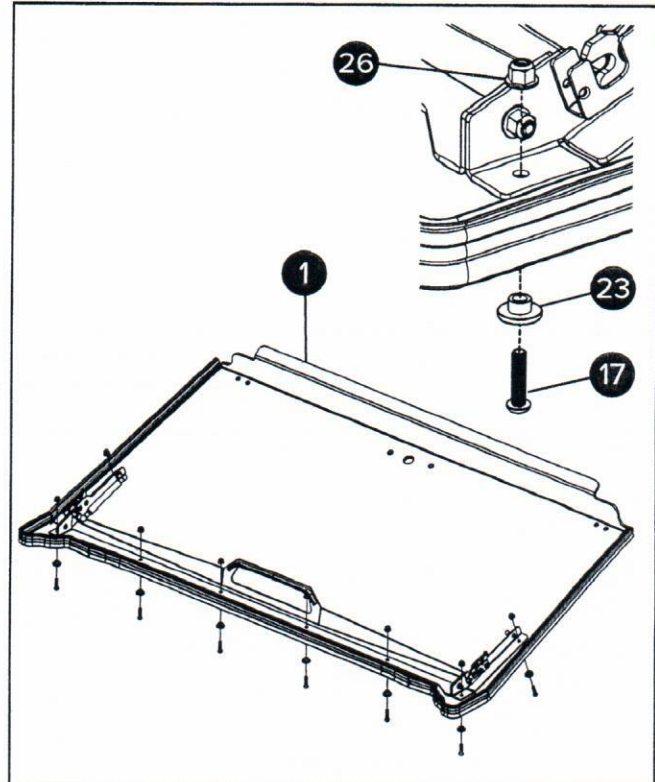

12. Insert the 1" Plug (21) and both 1/2" Plugs (22) into the three holes in the outside of the Windshield (1).

- Leave all holes open if a Windshield Wiper Kit is being installed

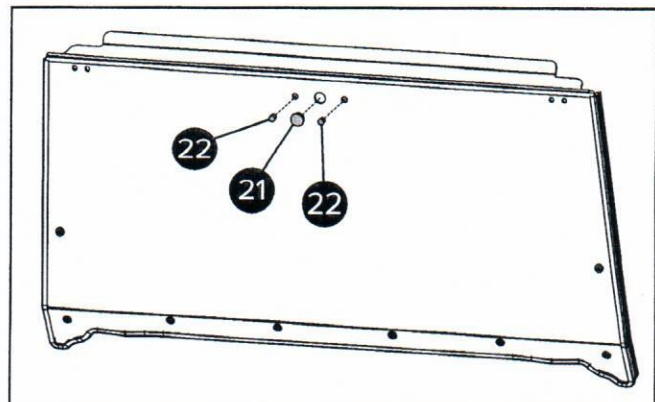

13. Install an M6 Ball Stud (24) to the Driver Side Mounting Bracket (6) using one 6 x 45mm Carriage Bolt (25), M6 Fender Washer (20), and Steel Spacer (14).

- Install the hardware centered in the slots on the brackets at this time

TORQUE: 71 in/lbs (8.0 N·m, 0.82 kgf/m)

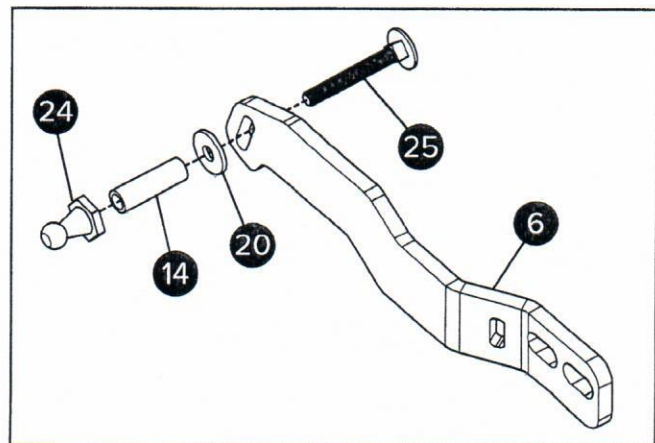

Installation Instructions

14. Install an M6 Ball Stud (24) to the Passenger Side Mounting Bracket (7) using one 6 x 45mm Carriage Bolt (25), M6 Fender Washer (20), and Steel Spacer (14).

- *Install the hardware centered in the slots on the brackets at this time*

TORQUE: 71 in/lbs (8.0 N·m, 0.82 kgf/m)

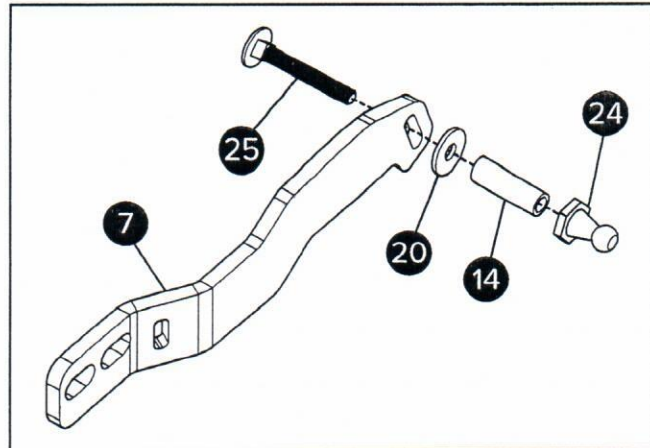

- 15.. Remove the Net Striker Brackets (A) from the bases of both A-Pillar ROPS tubes. Set aside both brackets and all four nuts (B) to be reinstalled. The stock bolts (C) will not be used to install the windshield.

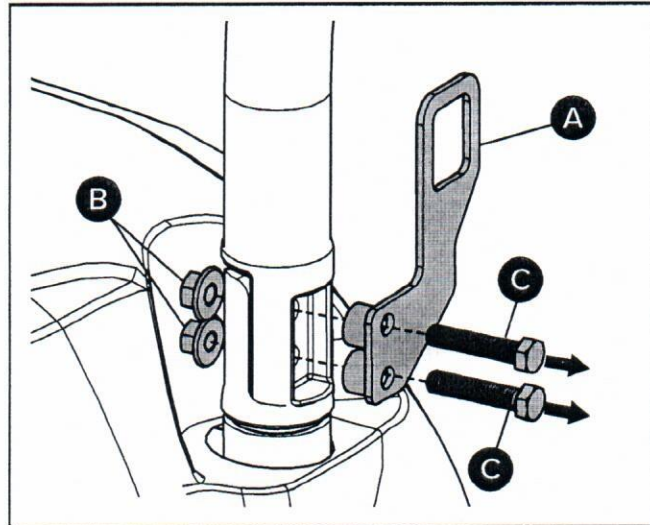

16. Place the Driver Side Mounting Bracket (6) behind the holes in the base of the ROPS tube between the tube and the plastic body panel. Reinstall the Net Striker Bracket (A) using the nuts removed in Step 13 (B) and two 3/8" x 2.25" Hex Head Bolts (19).

- *DO NOT reinstall the stock bolts*

TORQUE: 33 ft/lb. (45 N·m, 4.6 kgf/m)

