

NOTE: It is recommended that bolts remain "hand tight" until all bolts are installed.

HARDWARE LIST:

- 3/8" X 1" Hex Head Bolt with Flanged Nylock Nut _____ x 2
- 5/16-18 X 3/4" Self-Threading Bolt _____ x 4
- 3/8" X 2" Carriage Bolt with Flanged Nylock Nut _____ x 2
- 5/16" X 1 3/4" Carriage Bolt with Flanged Nylock Nut _____ x 4

FIGURE 1.

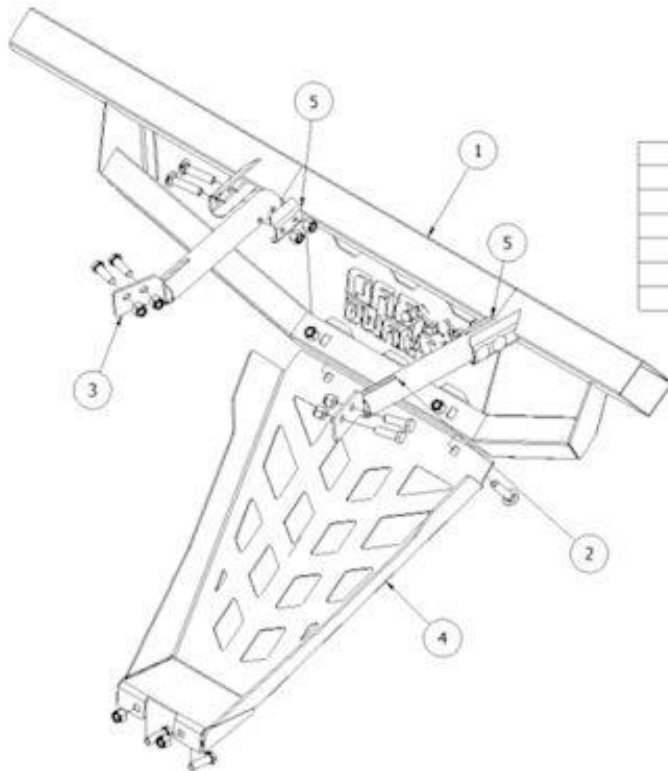

| Parts List | | |
|------------|-----|--------------------------|
| ITEM | QTY | DESCRIPTION |
| 1 | 1 | Bumper Face |
| 2 | 1 | Side Mount Bracket Left |
| 3 | 1 | Side Mount Bracket Right |
| 4 | 1 | Skid Plate Support |
| 5 | 2 | Support Bracket |

**INSTALLATION INSTRUCTIONS: RZR S SERIES
REAR SQUARE TUBE BUMPER**

STEP 1.

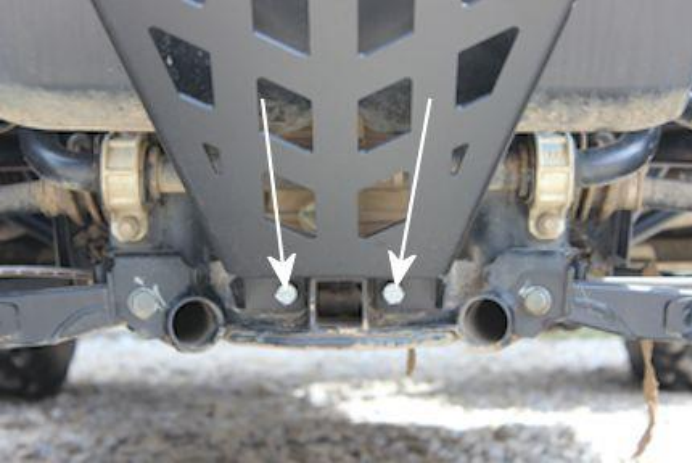

1. Using the provided 3/8" x 1" Hex Head Bolts, loosely bolt the Skid Plate Support (item 4) to the bottom of the frame as shown.

STEP 2a.



1. Remove the snap in hole covers from the location shown in this illustration.
2. Locate the Passenger Side Mount Bracket (item 3) with the offset holes to the top (refer to the illustration in Figure 1).

STEP 2b.



3. Locate the holes to be used, shown here.
4. Secure the brackets to the location shown in this illustration using the provided 5/16-18 x 3/4" Self-Threaded Bolts (passenger side is shown here).
5. Repeat on the other side using (item 2).

Note: A pneumatic impact tool with a longer socket extension is useful in this step.

**INSTALLATION INSTRUCTIONS: RZR S SERIES
REAR SQUARE TUBE BUMPER**

STEP 3.



1. Align the pre-cut holes in the bottom rail of the Bumper Face (item 1) to the corresponding holes of the Skid Plate Support (item 4) according to this illustration.
2. Insert the provided 3/8" x 2" Carriage Bolt and nut.

STEP 4

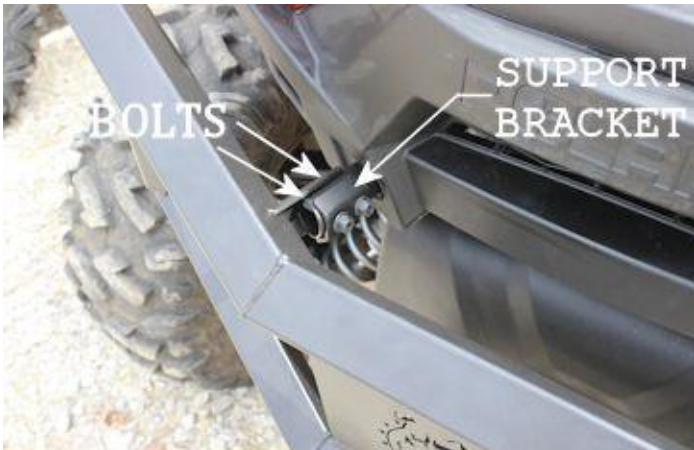

1. Align the pre-cut holes of the top, bumper face, bracket with the corresponding holes of the Side Mount Brackets (items 2,3) and insert the provided 5/16" x 1 3/4" Carriage Bolts.
2. Place the Support Bracket (item 5) over the inserted bolts and secure with the provided Nylock Nuts as shown in this illustration.
3. Repeat on the other side (Driver side shown here).

STEP 5



1. Make adjustments to position the bumper.
2. When satisfied, tighten all the bolts starting with the Side Mount Brackets (where it attaches to the frame) working your way out and down until all are tight.