

**INSTALLATION INSTRUCTIONS: Intimidator
Front Bumper**

It is recommended that bolts remain "hand tight" until all bolts are installed.

Parts List		
ITEM	QTY	DESCRIPTION
1	1	Bumper
2	1	Skid Plate
3	1	Left Mounting Bracket
4	1	Right Mounting Bracket

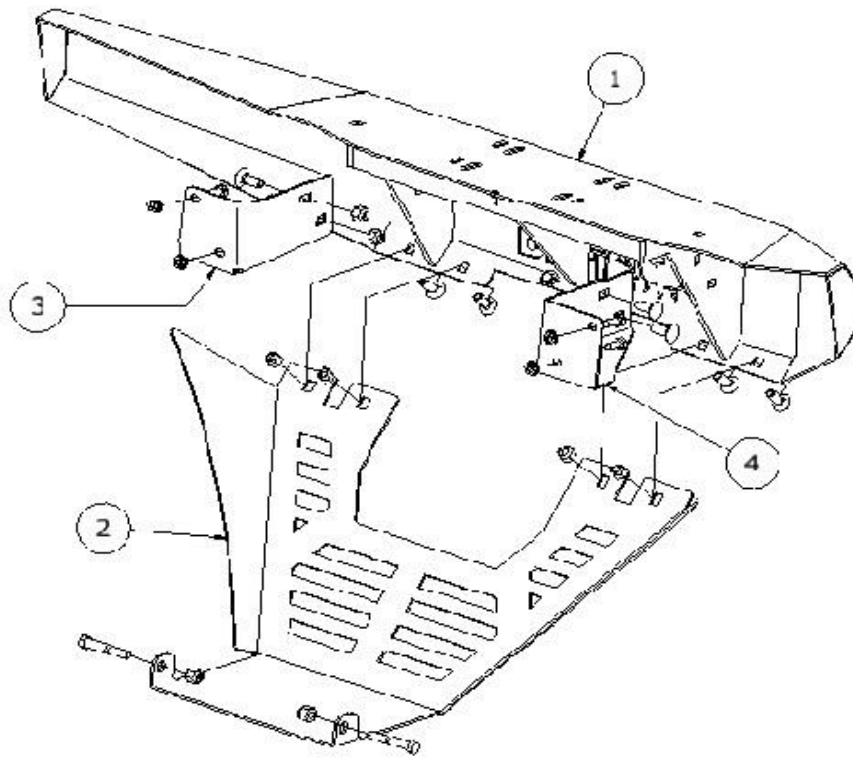

Figure 1



INSTALLATION INSTRUCTIONS: Intimidator Front Bumper

Hardware list:

- B1.** 3/8 X 3/4" carriage bolt with flanged Nylock nut (black) _____ x 8
- B2.** 3/8 X 2" hex head bolt with flanged Nylock nut _____ x 2

1. Remove the stock bumper and retain the mounting nuts and bolts, you will use them to mount the new bumper.
2. Install Left and Right Mounting Brackets (items 3 & 4) according to the illustration (figure 1) by using the factory mounting nuts and bolts.
3. Install the Bumper (item 1) by aligning the holes of the Left and Right Mounting Brackets with the corresponding holes in the outside gussets of the Bumper using bolts (B1). Take care to place the Mounting Brackets to the outside of the gussets.
4. To install the Skid Plate (item 2) on a Base Model Intimidator, locate the holes on the 1-1/2" Square tube on the bottom of the frame identified by the angle cut on the end of the frame tube (figure 2. [shown with front receiver hitch installed available on upgraded models]). Place the top Flange of the Skid plate on the inside of the Bumper (item 1.) Align the bottom holes of the Skid Plate with the holes in the before mentioned 1-1/2" square tube and secure with bolts (B2). NOTE: If you have an upgraded model that includes a front receiver hitch, you may use the factory bolts.
5. Align the top holes of the Skid Plate (item 2) with the corresponding holes in the Bumper (item 1) with top flange on the inside of the Bumper and secure with bolts (B1).
6. Starting with the factory bolts on the Mounting Brackets, tighten all bolts.
7. Enjoy your new Bad Dawg Bumper!

***INSTALLATION INSTRUCTIONS: Intimidator
Front Bumper***



Figure 2



Finished bumper shown with optional Bull Bar